

## Dimensions & Specifications

Model Number	Outline (mm)			Block Dimensions (mm)									Rail Dimensions (mm)						Weight	
	Height H	Width W	Length L	B	C	M x T	K	G	Z	N	J	E	P	V	X	A	F	Q x R x S	Block (kg)	Rail (kg/m)
WRC 21/15 MN	21	54	57.5	31	19	M5 x 5	18.3	40.3	6	M3 x 6.5	3.3	3.5	37	22	8.5	14.4	50	4.5 x 7.5 x 5.3	0.16	3.60
WRC 27/20 MN	27	62	70	46	32	M6 x 6	23.5	52	9	M3 x 7.5	4.5	3.5	42	24	10	18.5	60	4.5 x 7.5 x 5.3	0.32	5.26

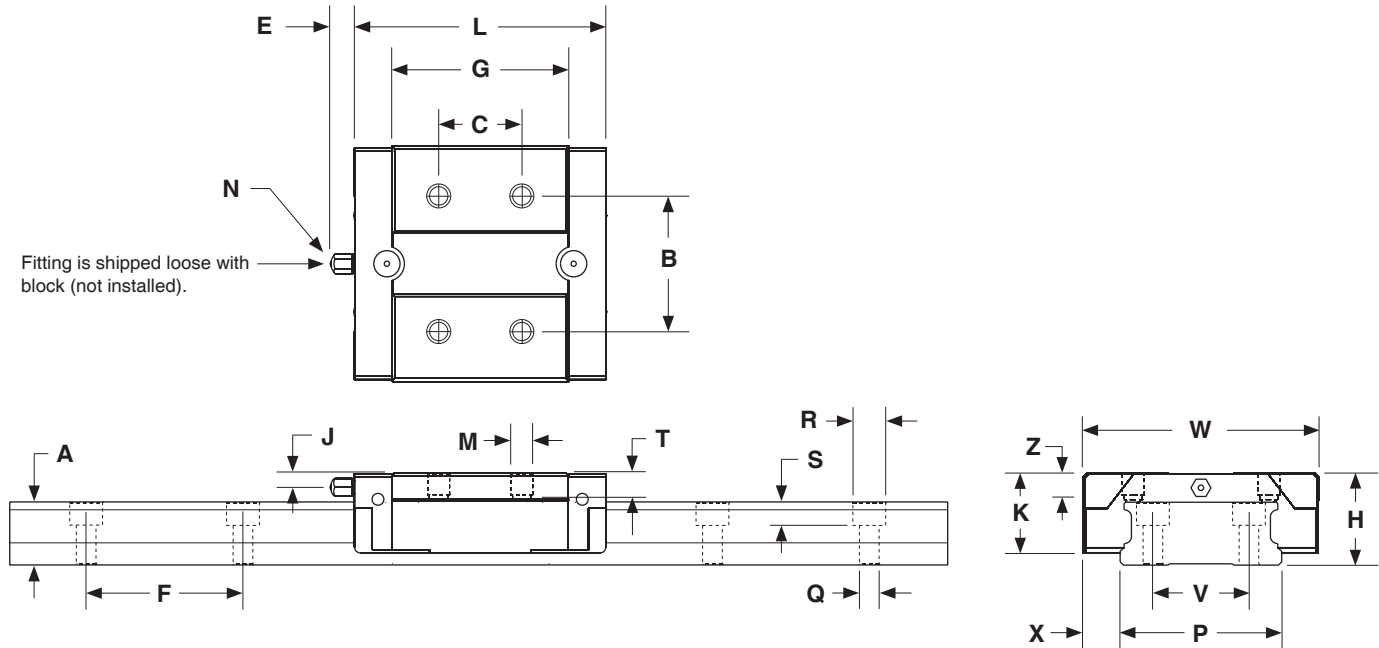

Rail Size	(mm)				
	D x Y	P	A	F	U
WRCU 21/15	M4 x 8	37	14.4	50	22
WRCU 27/20	M5 x 7.5	42	18.5	60	24

Rail Tapped from Bottom

