

Dimensions & Specifications: **LBOM** Linear Bushing Open Metric (Asian Style)

Model Number		Nominal Shaft Diameter (mm)	Dynamic Load Capacity (N)	Housing Bore D (mm)	Dimensions (mm)				Angle a	# of Ball Circuits	Bearing Weight (g)
Without Seals	With Seals				A	B	C	E _{min.}			
LBOM-16	-S	16	1372	28	37	26,5	1,60	11,0	60°	4	26
LBOM-20	-S	20	2332	32	42	30,5	1,60	11,0	60°	5	48
LBOM-25	-S	25	4351	40	59	41,0	1,85	12,5	60°	5	100
LBOM-30	-S	30	4851	45	64	44,5	1,85	15,0	60°	5	122
LBOM-40	-S	40	9408	60	80	60,5	2,15	20,0	60°	5	262

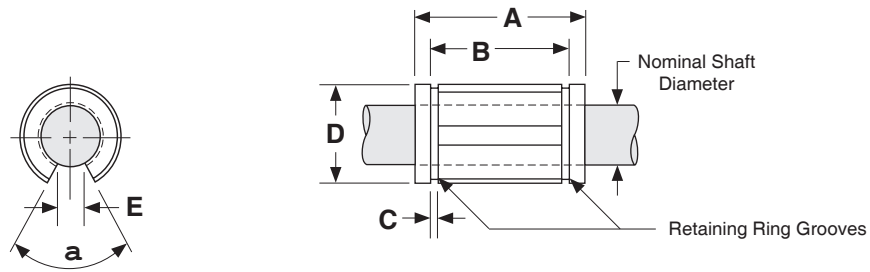

Footnotes:

- (1) Rating based upon 50 km of travel with the load forces being applied downward on the linear bearing, while in a horizontal application, and based upon 1060 steel shafting (Rockwell 60C).
- (2) This specification is based upon the bearing being on the shaft.