

Dimensions & Specifications: **LBOME** Linear Bushing Open Metric (European Style)

Model Number		Nominal Shaft Diameter (mm)	Dynamic Load Capacity (N)	Housing Bore D (mm)	Dimensions (mm)				Angle a	# of Ball Circuits	Bearing Weight (g)
Without Seals	With Seals				A	B	C	E _{min.}			
LBOME-12	-S	12	1020	22	32	22,9	1,30	6,5	66°	4	17
LBOME-16	-S	16	1250	26	36	24,9	1,30	9,0	68°	4	35
LBOME-20	-S	20	2090	32	45	31,5	1,60	9,0	55°	5	48
LBOME-25	-S	25	3780	40	58	44,1	1,85	11,5	57°	5	103
LBOME-30	-S	30	5470	47	68	52,1	1,85	14,0	57°	5	177
LBOME-40	-S	40	6590	62	80	60,6	2,15	19,5	56°	5	275
LBOME-50	-S	50	10800	75	100	77,6	2,65	22,5	54°	5	520

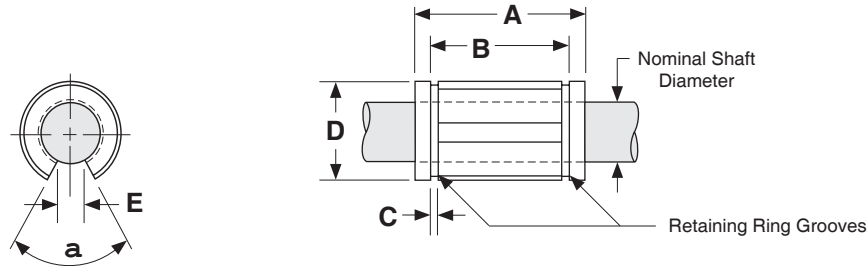

Footnotes:

- (1) Rating based upon 50 km of travel with the load forces being applied downward on the linear bearing, while in a horizontal application, and based upon 1060 steel shafting (Rockwell 60C).
- (2) This specification is based upon the bearing being on the shaft.