

## Dimensions & Specifications: LBOA Precision Ball Bushing (open)

Model Number		Nominal Shaft Diameter (inches)	Working Bore Diameter (inches)	Dyn. <sup>(1)</sup> Load Capacity (lbs)	Dimensions (inches)					Bearing Weight (lbs)
Without Seals	With Seals <sup>(2)</sup>				A	B	C	D	E min.	
LBOA-8	-S	0.500	0.5005/0.4995	60	1.250/1.235	0.967/0.951	0.046	0.8760/0.8746	0.31	0.07
LBOA-10	-S	0.625	0.6255/0.6245	105	1.500/1.485	1.108/1.092	0.056	1.1260/1.1240	0.38	0.11
LBOA-12	-S	0.750	0.7505/0.7495	140	1.625/1.610	1.170/1.154	0.056	1.2510/1.2490	0.44	0.17
LBOA-16	-S	1.000	1.0005/0.9995	240	2.250/2.235	1.759/1.741	0.068	1.5635/1.5615	0.56	0.32
LBOA-20	-S	1.250	1.2506/1.2494	400	2.625/2.605	2.009/1.991	0.068	2.0010/1.9990	0.63	0.90
LBOA-24	-S	1.500	1.5006/1.4994	600	3.000/2.980	2.415/2.397	0.086	2.3760/2.3740	0.75	1.12
LBOA-32	-S	2.000	2.0008/1.9992	860	4.000/3.980	3.195/3.177	0.103	3.0010/2.9990	1.00	2.16

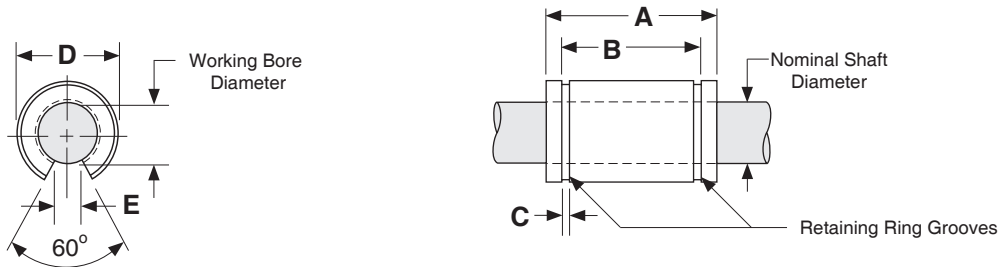

### Footnotes:

- (1) Rating based upon 2 million inches of travel with the load forces being applied downward on the linear bearing, while in a horizontal application, and based upon 1060 steel shafting (Rockwell 60C). The actual load rating, and life, is dependent upon several factors.
- (2) The bearing retainer is plastic when the internal -S seal option is selected.