

Dimensions & Specifications: **LBCM** Linear Bearing Closed Metric (Asian Style)

Model Number		Nominal Shaft Diameter (mm)	Dynamic Load Capacity N (Kgf)	Housing Bore D (mm) ⁽²⁾	Dimensions (mm)			No. of Ball Tracks	Bearing Weight (kg)
Without Seals	With Seals				A	B	C		
LBCM-16	LBCM-16-S	16	1225 (119,9)	28	37	26,5	1,60	5	0,034
LBCM-20	LBCM-20-S	20	2303 (239,8)	32	42	30,5	1,60	6	0,058
LBCM-25	LBCM-25-S	25	4312 (459,6)	40	59	41,0	1,85	6	0,120
LBCM-30	LBCM-30-S	30	4802 (569,6)	45	64	44,5	1,85	6	0,148
LBCM-40	LBCM-40-S	40	9310 (949,3)	60	80	60,5	2,10	6	0,314

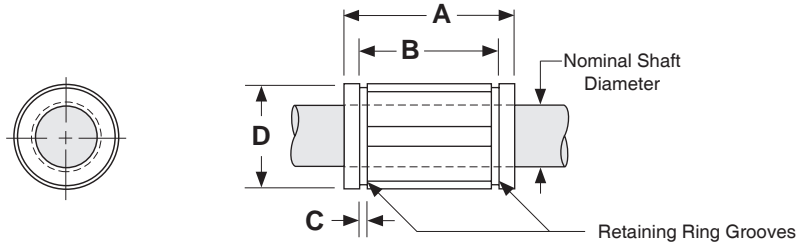

Footnotes:

- (1) Rating based upon 50 km of travel with the load forces being applied downward on the linear bearing, while in a horizontal application, and based upon 1060 steel shafting (Rockwell 60C).
- (2) This specification is based upon the bearing being on the shaft.