

Dimensions & Specifications: **LBCH** High Capacity Linear Bushing (closed)

Model Number		Nominal Shaft Diameter (inches)	Dyn. ⁽¹⁾ Load Capacity (lbs)	# of Ball Circuits	Working Bore Diameter (inches)	Housing Bore D (inches)	Dimensions (inches)			Bearing Weight (lbs)
							A	B	C	
LBCH-12	-S	0.750	1,130	10	0.7500/0.7495	1.2505/1.2500	1.625/1.605	1.270/1.250	0.056	0.13
LBCH-16	-S	1.000	1,900	10	1.0000/0.9995	1.5630/1.5625	2.250/2.230	1.890/1.870	0.068	0.28
LBCH-20	-S	1.250	2,350	10	1.2500/1.2494	2.0008/2.0000	2.625/2.600	2.001/1.985	0.068	0.53
LBCH-24	-S	1.500	3,880	10	1.5000/1.4994	2.3760/2.3750	3.000/2.970	2.420/2.390	0.086	0.84

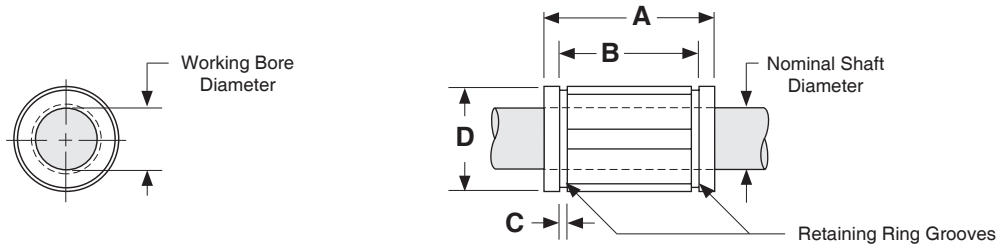

Footnotes:

(1) Rating based upon 2 million inches of travel with the load forces being applied downward on the linear bushing, while in a horizontal application, and based upon 1060 steel shafting (Rockwell 60C).

(2) This specification is based upon the bushing being on the shaft.