

Dimensions & Specifications: **LBCA** Precision Linear Bearing (closed)

| Model Number | | Nominal Shaft Diameter (inches) | Working Bore Diameter (inches) | Dyn. ⁽¹⁾ Load Capacity (lbs) | Dimensions (inches) | | | | Bearing Weight (lbs) |
|---------------|---------------------------|------------------------------------|-----------------------------------|---|------------------------|-------------|-------|---------------|-------------------------|
| Without Seals | With ⁽²⁾ Seals | | | | A | B | C | D | |
| LBCA-4 | LBCA-4-S | 0.250 | 0.2500/0.2495 | 19 | 0.750/0.735 | 0.515/0.499 | 0.039 | 0.5000/0.4996 | 0.02 |
| LBCA-6 | LBCA-6-S | 0.375 | 0.3750/0.3745 | 37 | 0.875/0.860 | 0.640/0.624 | 0.039 | 0.6250/0.6246 | 0.06 |
| LBCA-8 | LBCA-8-S | 0.500 | 0.5000/0.4995 | 85 | 1.250/1.235 | 0.967/0.951 | 0.046 | 0.8750/0.8746 | 0.08 |
| LBCA-10 | LBCA-10-S | 0.625 | 0.6250/0.6245 | 150 | 1.500/1.485 | 1.108/1.092 | 0.056 | 1.1250/1.1246 | 0.16 |
| LBCA-12 | LBCA-12-S | 0.750 | 0.7500/0.7495 | 200 | 1.625/1.610 | 1.170/1.154 | 0.056 | 1.2500/1.2496 | 0.21 |
| LBCA-16 | LBCA-16-S | 1.000 | 1.0000/0.9995 | 350 | 2.250/2.235 | 1.759/1.741 | 0.068 | 1.5625/1.5621 | 0.38 |
| LBCA-20 | LBCA-20-S | 1.250 | 1.2500/1.2494 | 520 | 2.625/2.605 | 2.009/1.991 | 0.068 | 2.0000/1.9995 | 1.10 |
| LBCA-24 | LBCA-24-S | 1.500 | 1.5000/1.4994 | 770 | 3.000/2.980 | 2.415/2.397 | 0.086 | 2.3750/2.3745 | 1.43 |
| LBCA-32 | LBCA-32-S | 2.000 | 2.0000/1.9992 | 1,100 | 4.000/3.980 | 3.195/3.177 | 0.103 | 3.0000/2.9994 | 2.75 |

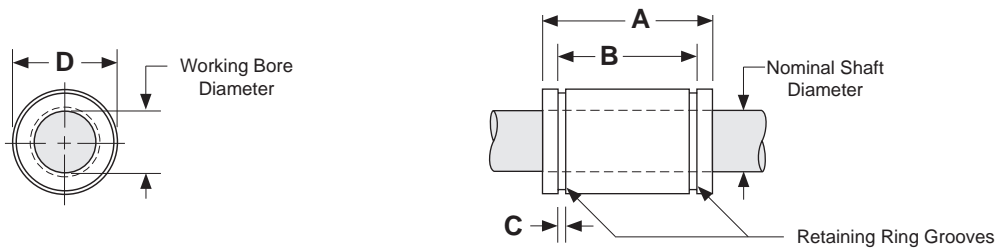

Footnotes:

- (1) Rating based upon 2 million inches of travel with the load forces being applied downward on the linear bearing, while in a horizontal application, and based upon 1060 steel shafting (Rockwell 60C). The actual load rating, and life, is dependent upon factors detailed on pages 6 to 11.
- (2) The bearing retainer is plastic when the internal -S seal option is selected.