

## Dimensions & Specifications

Model Number	Outline (mm)			Block Dimensions (mm)								Rail Dimensions (mm)						Weight	
	Height H	Width W	Length L	B	C	M x T	K	G	N	J	E	P	X	A	F	Q x R x S	Block (kg)	Rail (kg/m)	
ARC 15 MS			41.2		-			26									0.11		
ARC 15 MN	24	34	55.5	26	26	M4 x 7	20.7	40.3	M3 x 6.5	4.5	5.3	15	9.5	15	60	4.5 x 7.5 x 5.3	0.16	1.29	
ARC 15 ML			76.2		34			61									0.24		
ARC 20 MS			49.2		-			32.2									0.17		
ARC 20 MN	28	42	69	32	32	M5 x 7	23	52	M3 x 7.5	4	10	20	11	20	60	6 x 9.5 x 8.5	0.27	2.28	
ARC 20 ML			87.2		45			70.2									0.33		
ARC 25 MS			57.4		-			38.4									0.30		
ARC 25 MN	33	48	81.2	35	35	M6 x 9	27	62.2	M6 x 7.5	5	12	23	12.5	23	60	7 x 11 x 9	0.42	3.02	
ARC 30 MS			68		-			44									0.56		
ARC 30 MN	42	60	95.5	40	40	M8 x 12	35.2	71.5	M6 x 8.5	7.5	12	28	16	27	80	9 x 14 x 12	0.80	4.38	
ARC 30 ML			118		60			94									1.14		
ARC 35 MN			111.2		50			86.2									1.12		
ARC 35 ML	48	70	136.6	50	72	M8 x 13	40.4	111.6	M6 x 10	8	12	34	18	32	80	9 x 14 x 12	1.54	6.79	
ARC 45 MN			135.5		60			102.5									2.12		
ARC 45 ML	60	86	171.5	60	80	M10 x 17	50.7	138.5	PT1/8 x 12.5	11.1	14	45	20.5	39	105	14 x 20 x 17	3.16	10.53	
ARC 55 MN			168.5		75			126.5									4.20		
ARC 55 ML	70	100	202	75	95	M12 x 20	58	160	M6 x 10	13.5	12	53	23.5	45.7	120	16 x 24 x 20	5.08	14.0	

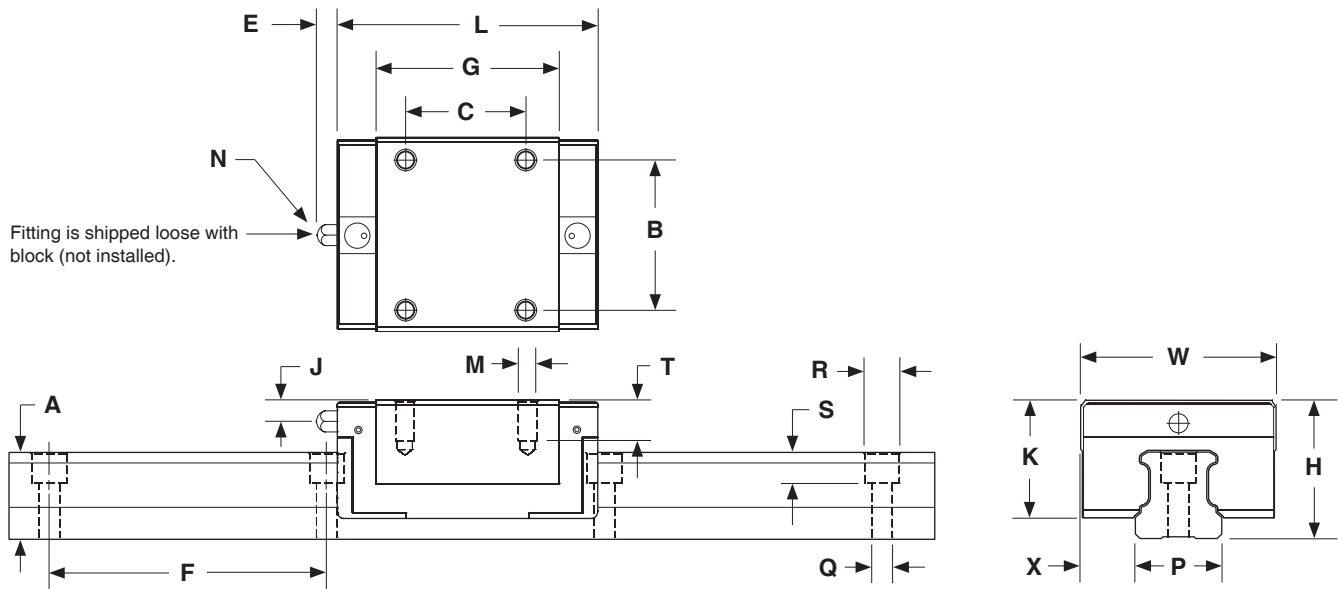

Rail Size	(mm)			
	D x Y	P	A	F
ARCU 15	M5 x 8	15	15	60
ARCU 20	M6 x 10	20	20	60
ARCU 25	M6 x 12	23	23	60
ARCU 30	M8 x 15	28	27	80
ARCU 35	M8 x 15	34	32	80
ARCU 45	M12 x 19	45	39	105
ARCU 55	M14 x 24	53	45.7	120

Rail Tapped from Bottom

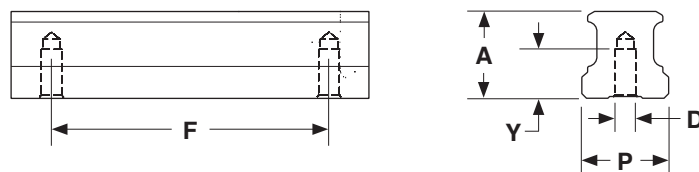

Specifications subject to change without notice